

No. 169  
500 as.

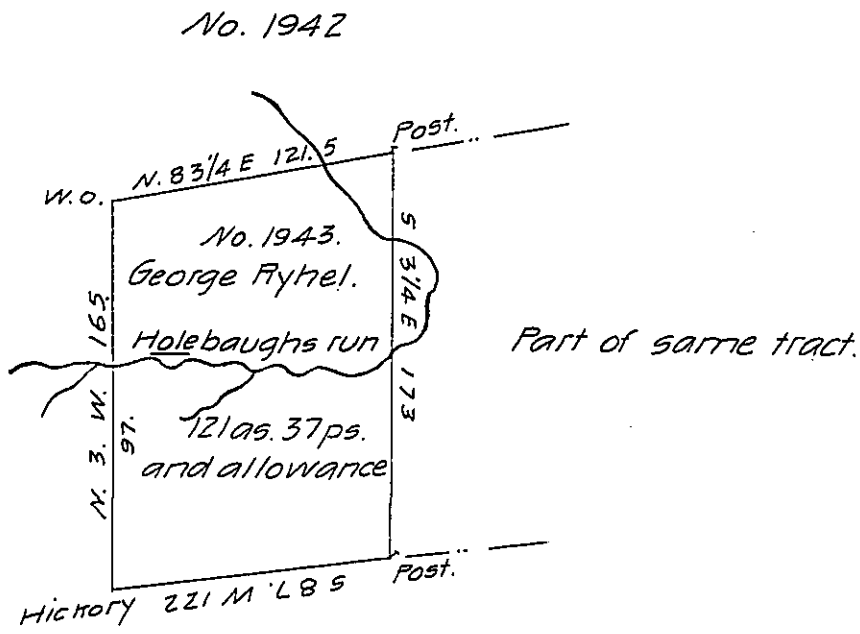

No. 1944.

This is a draft of the western half of Donation Lott No. 1943. Situate in Slipperyrock Township, Mercer County in the Second district of Donation land. Surveyed the 13th day of July 1831, for George Fyhel Containing one hundred and twenty one acres 37 perches and the usual allowance for roads & c. The whole tract was surveyed in 1824. Survey returned to the office. Bounded as above.

A. Brown D.S.

Jacob Sparger Esqr. S.G.

Note. It was very bad weather when first surveyed. The difference in the quantity of land shows that the chain carriers had made bad work. A.B. —

IN TESTIMONY that the above is a copy of the original remaining on file in the Department of Internal Affairs of Pennsylvania, made conformably to an Act of Assembly approved the 16th day of February, 1833, I have hereunto set my Hand and caused the Seal of said Department to be affixed at Harrisburg, this fifth day of December 1906

*Geo. D. Brown*  
Secretary of Internal Affairs.